

Lighting up spaces with innovation

# DMuseum

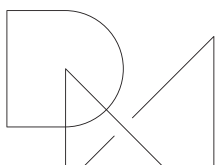

**DMUSEUM Inc.**  
|주디뮤지엄

**PRODUCT INTRODUCTION**  
**2024-25**

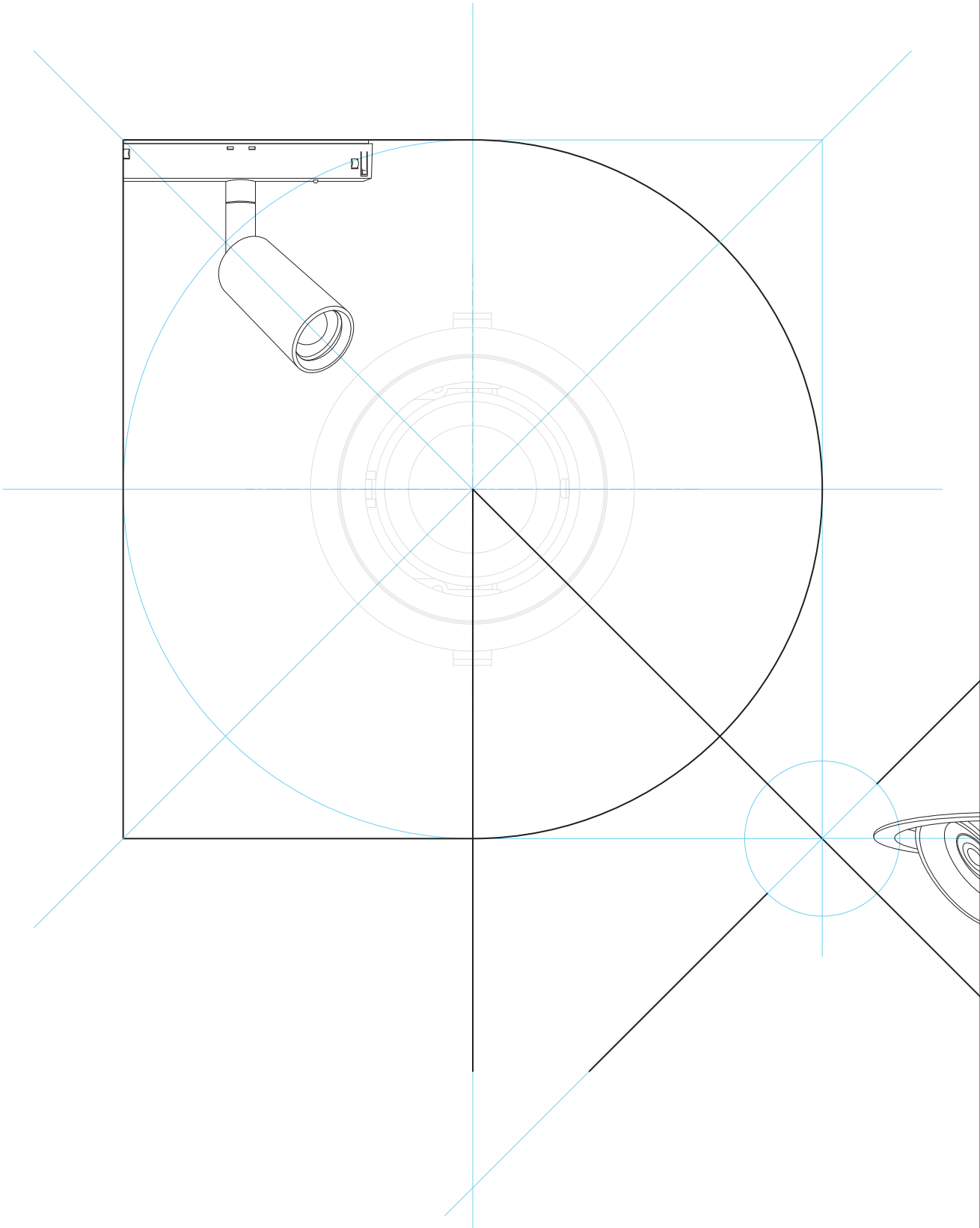

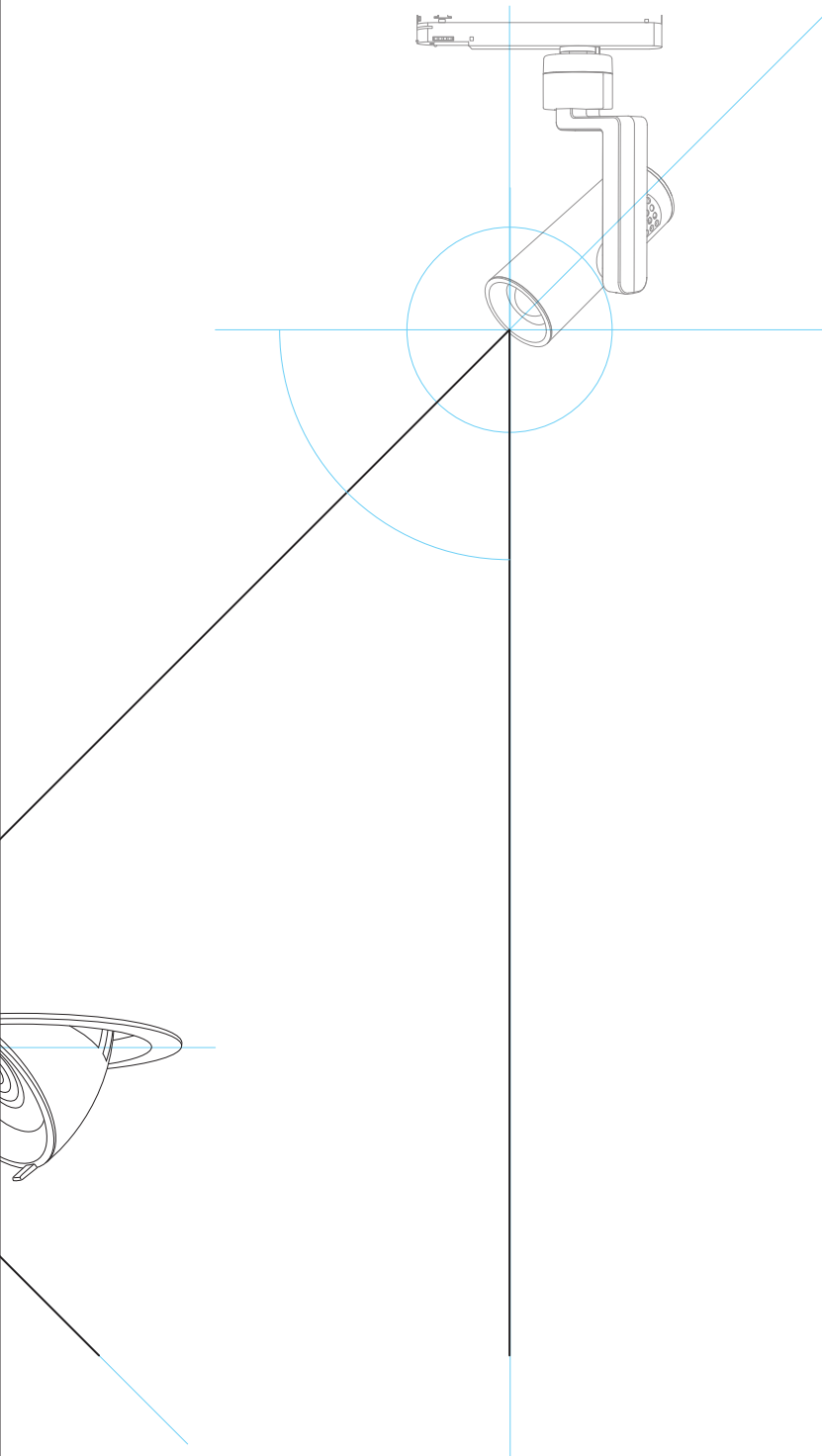

## Table of Contents

### 01 Company Overview

About DMUSEUM Inc  
Business Areas

### 02 Core Technologies

Optical system  
Tunable COB  
Luminair system  
Motorized light control

### 03 Product Introduction

#### Spotlight

DL-09  
DL-20

#### Downlight

DL-35

4-wire 3-phase track

### 04 Appendix

Cotrol system  
Contact us













# Illuminating Art with Light, Creating Emotional Experiences through Spatial Expression

DMUSEUM Inc. is a leading company that merges art and technology to create emotionally engaging and inspiring spaces. We are dedicated to offering sustainable and innovative exhibition lighting and control solutions.

In the rapidly changing global market, we aim to lead the way by sharing advanced lighting technologies and trends, and by introducing new lighting cultures.

Through the development and production of eco-friendly products, and by implementing social values in a harmonious way, we will continue to secure sustainable competitive advantages and grow into the world's top exhibition lighting specialist.

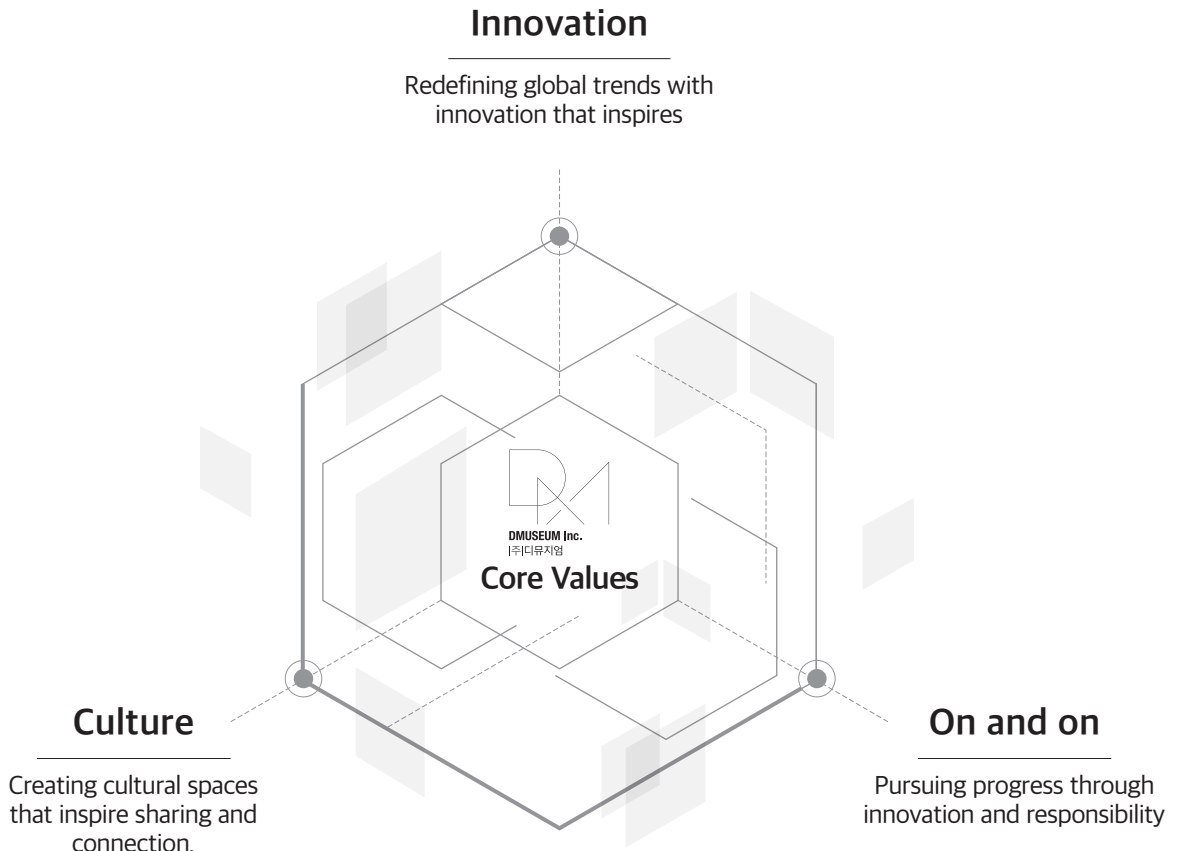



DMUSEUM Inc. leads the future of exhibition culture through cutting-edge lighting technology, spatial design, and immersive media experiences. We specialize in creating curated environments that inspire, inform, and connect—with innovation at the heart of every project.

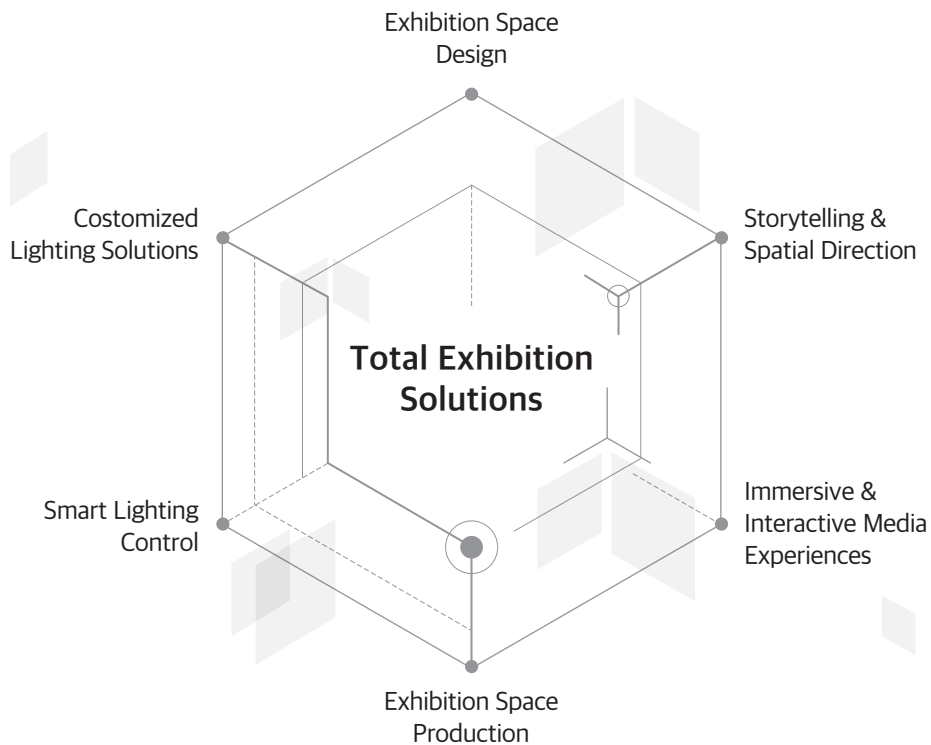

# Core Technologies of DMUSEUM Inc.

DMUSEUM Inc. not only manufactures exhibition lighting, but also provides smart control systems that enhance usability and convenience.

As the only company in Korea to receive the Minister of Trade, Industry and Energy Award, we offer advanced motorized lighting control technology. This enables precise control of fixture movement, brightness, color temperature, and beam angle.

We also provide optimized lighting design solutions that reflect our deep expertise in exhibition space planning and spatial experience.





## Smart Lighting Technology for Optimal Spatial Expression

### Moving

Motion & Color  
Temperature Control

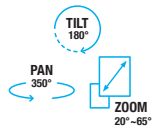

Motorized 3-axis control of lighting fixtures : pan, tilt, zoom  
Adjustable beam angles and directional focus  
Dynamic light movement enhances emphasis on displayed objects  
Anti-glare control for improved viewing comfort

### Automation

Personalized  
Automatic Control



Integrated with various devices and apps for automated lighting scenarios  
Customized lighting settings based on exhibition themes  
Scheduling and scene presets for seamless operation

### Smart connecting

Remote Lighting  
Management



Bluetooth mesh network for stable, multi-device connectivity  
Real-time control of color temperature, dimming, beam shaping, and movement  
Instant adaptability to user needs and exhibition requirements

Optical system

# Safe and Accurate Illumination with High CRI COB and Heat-Controlled Design

DMUSEUM Inc. combines advanced technology and design to deliver lighting solutions that protect exhibits and enhance viewer experience.D-Light ensures safe, detailed illumination—especially for sensitive materials—while supporting the visual beauty of each piece.



## High-Performance COB for Even Light Distribution

We use top-tier Bridgelux COB modules to provide consistent, high-CRI lighting (CRI 94+), adjustable color temperatures (2700K-6500K), and minimal glare—ideal for preserving both exhibits and visual clarity.



## Heat Control & Dimming for Conservation

All products include dimming control for precise lighting adjustment.Built-in heat dissipation structures prevent thermal damage, ensuring a stable and safe exhibition environment.

### ICOM Lighting Standards for Museums (International Council of Museums)

| Material Type                  | Recommended Annual Illuminance(Lux/h) |
|--------------------------------|---------------------------------------|
| Metals, Ceramics, Glass, Stone | 450 lux or less                       |
| Wood, Paper, Leather           | ≤220 lux (≤500,000 lux·hours/year)    |
| Silk, Textiles                 | ≤80 lux (≤240,000 lux·hours/year)     |
| Painting                       | ≤100 lux (≤300,000 lux·hours/year)    |



## Tunable COB

# Creating Atmosphere Through Color Temperature Control

Lighting sets the tone of a space—and color temperature is key to shaping mood and emotional impact.

Warm tones (lower color temps) offer a cozy, intimate feel, while cool tones (higher color temps) create a calm and refined atmosphere.



## Color Tuning for Curated Exhibition Experiences

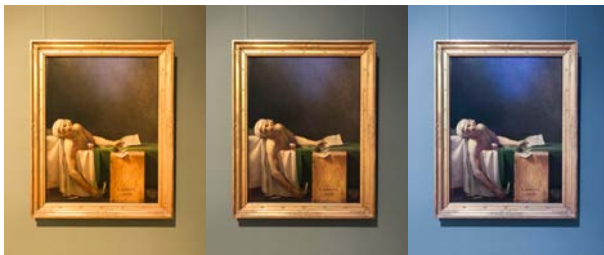

Precise color temperature control enhances the presentation of artworks and helps convey the unique character of each piece. For example, the same painting may be perceived in completely different ways depending on the color temperature—highlighting emotional or visual depth.

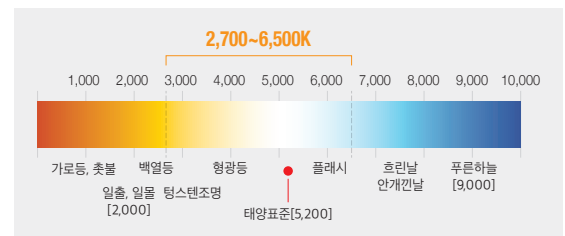

DMUSEUM Inc's Tunable COB technology supports a full spectrum from 2700K to 6500K, enabling seamless adjustment to suit any exhibition environment. With CRI 94+, our lighting ensures vivid color fidelity, preserving the artist's original intent and enriching the overall viewing experience.

## Luminair system

# Precision Light Control for Sophisticated Exhibition Spaces

Lighting plays a crucial role in enhancing exhibits while ensuring a calm and safe viewing experience. DMUSEUM Inc.'s lighting technology allows for detailed control of direction, brightness, color, and beam angle—transforming the space itself into a curated work of art.

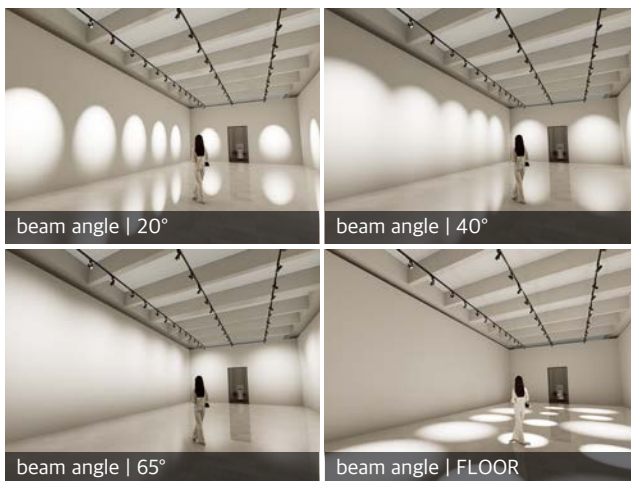

## Zoom Control for Flexible & Precise Focus

With adjustable beam angles ranging from 20° to 65°, D-Light enables customized lighting for different exhibit types and spatial contexts. Full smart control—including on/off, dimming, CCT, color, pan, and tilt—lets curators fine-tune lighting for artworks, ensuring smooth transitions and minimal glare. This technology supports a wide range of exhibition styles, from galleries to museums, and brings a refined touch to lighting presentation.

## Simple & Intelligent Smart Control System



Our smart control solutions expand creative possibilities in exhibition lighting. Using remotes, smartphones, or tablets, users can easily adjust lighting movement, direction, beam angle, CCT, and brightness—all in real time. This system delivers maximum flexibility with minimal hardware, allowing for adaptive lighting that aligns perfectly with the curator's intent and spatial design goals.

## Motorized light control

# Innovative Motorized Lighting for Safe and Flexible Exhibition Environments



Exhibition ceilings are often 6-10 meters high, making manual adjustments to track lighting difficult and risky. DMUSEUM solves this with a motorized system that ensures both safety and convenience removing the need for hazardous repositioning during installation or operation.

## Full Motion Control with Precision Motors

D-Light features motorized pan (360°), tilt (180°), and zoom (20°-65°) functions, allowing users to fine-tune lighting positions remotely. The system is built on advanced industrial motor technology with internal memory, ensuring accurate beam positioning that stays in place long-term—even after power cycling.



## Smooth & Safe Lighting Transitions

This motorized system enables subtle light direction changes to reduce glare and enhance viewing comfort. By minimizing manual handling, DMUSEUM offers a safer working environment and more refined, adaptable exhibition lighting.

## Project References



Sherwood Hall Cultural Space





Sherwood Hall Cultural Space

## Project References



Sherwood Hall Cultural Space

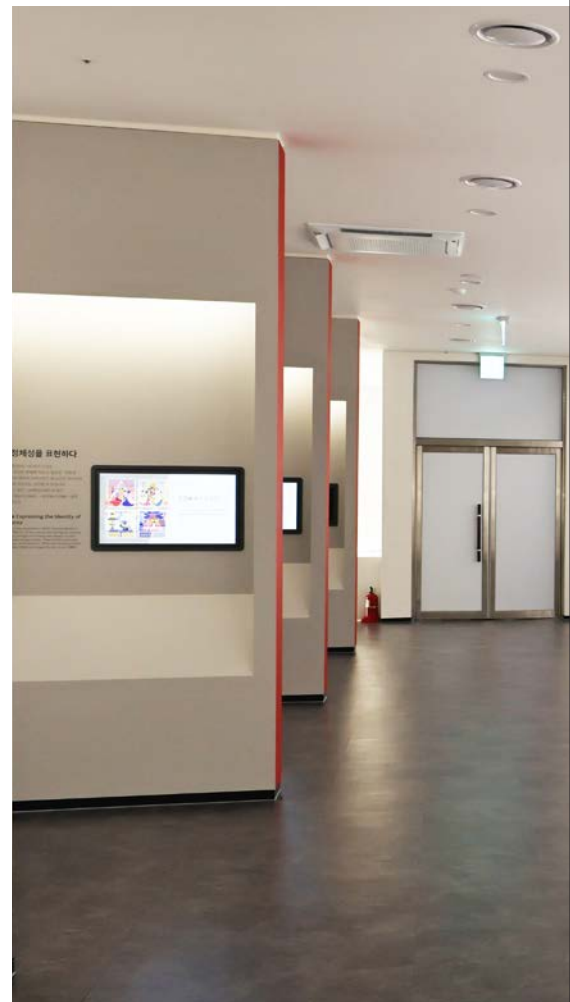

Sherwood Hall Cultural Space



1953 - 1970

### 대한결핵협회의 창립 모금의 물결이 시작되다

1953년 대한결핵협회의 창립과 함께 결핵 예방과 치료에 대한 관심이 높아지고, 결핵 예방을 위한 다양한 사업이 시작됩니다. 1953년 결핵 예방을 위한 다양한 사업을 시작합니다. 1953년 결핵 예방을 위한 다양한 사업을 시작합니다. 1953년 결핵 예방을 위한 다양한 사업을 시작합니다.

### The Founding of the Korea Tuberculosis Association and the Wave of Fundraising

The Korea Tuberculosis Association was founded in 1953, and with the National Tuberculosis Research Institute, it began the nationwide tuberculosis research project. The Association's goal is to prevent and cure tuberculosis, and it has been actively engaged in fundraising activities since its founding. The Association has been actively engaged in fundraising activities since its founding. The Association has been actively engaged in fundraising activities since its founding.

DL-20



Simple, Convenient, Safe, Innovative

# D-Light

DMUSEUM's motorized exhibition lighting system delivers seamless and precise control, optimizing spatial presentation through smooth operation and intelligent lighting technology.

DL-09



Track-3phase DM-401



DL-35



Control lighting effortlessly via app or remote using the Bluetooth MESH network. From Pan, Tilt, Zoom, and CCT to Dimming, all functions are wirelessly adjustable delivering a new standard in lighting that maximizes spatial flexibility and value.

# DL-20

DMuseum Inc. Motorized Smart Lighting



## Versatile and Intelligent Exhibition Spotlight - DL-20

The DL-20 is an 18-20W track spotlight with Bluetooth and RF-based smart control, enabling full remote operation. With tunable color temperature ranging from 2700K to 6500K, the DL-20 provides pan (350°), tilt (180°), and zoom beam angle (20°-65°) adjustments for highly flexible and detailed lighting control. Additional dimming functionality enhances spatial expression, highlighting exhibit features with precision and depth.

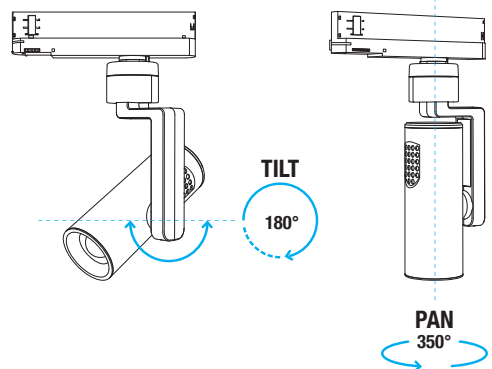

Dimensions

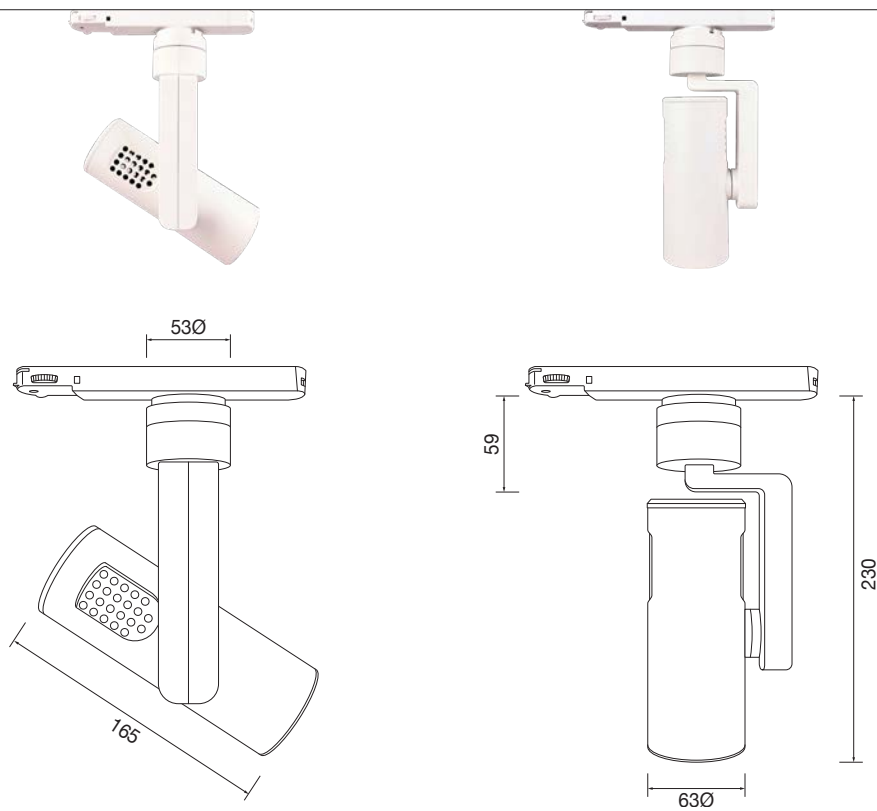

|                      |                        |
|----------------------|------------------------|
| Input Voltage        | AC 220-240V            |
| Power Consumption    | 20W                    |
| Output Voltage       | DC 48V                 |
| Frequency            | 50/60Hz                |
| Control Method       | CC/CV Control Method   |
| Luminous Flux        | 1840lm                 |
| Luminous Efficacy    | 104lm/w                |
| CRI(Color Rendering) | Ra>94                  |
| LED Source           | Bridgelux COB (Option) |
| Flicker Free         | Less than 1%           |
| Certification        | KC                     |
| Track type           | 4-wire 3-phase track   |
| Finish Color         | Black & White          |

|                  |                         |
|------------------|-------------------------|
| Communication    | Bluetooth Mesh 5.x      |
|                  | RF 315Mhz               |
| Pan              | 350°                    |
| Tilt             | 180°                    |
| CCT              | 2700K~6500K             |
| Beam angle(Zoom) | 20°~65°                 |
| Dimming          | 5%~100%                 |
| App              | Android                 |
| Max Connections  | 32,000                  |
| Control Range    | Up to 30m               |
| Scene Settings   | Supported               |
| Lens Material    | Silicon, PMMA(Optional) |
| Accessories      | Remote controller       |

# DL-09

DMuseum Inc. Motorized Smart Lighting



## Minimal Track Light for Flexible Installation

The DL-09 is a 9W track spotlight equipped with Bluetooth and RF-based remote control. Its minimal form factor makes it ideal for ceilings, shelves, walls, and other compact exhibition environments. With fully adjustable CCT (2700K-6500K), pan (350°), tilt (90°), zoom beam angle (20°-65°), and dimming, this model enables precise lighting control that aligns with the user's intent—perfect for curated lighting effects in any space.

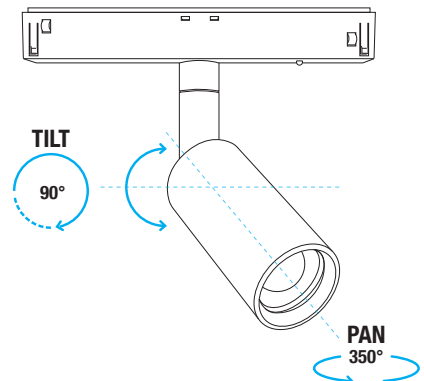

Dimensions

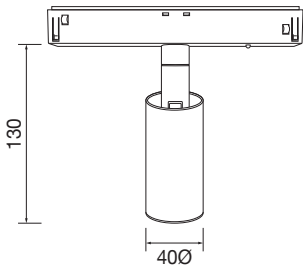
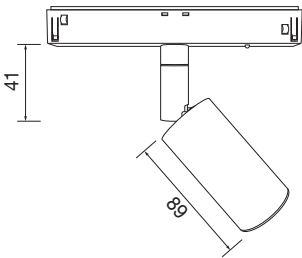

|                      |                        |
|----------------------|------------------------|
| Input Voltage        | DC 48V                 |
| Power Consumption    | 9W                     |
| Output Voltage       | DC 48V                 |
| Frequency            | 50/60Hz                |
| Control Method       | CC/CV Control Method   |
| Luminous Flux        | 979lm                  |
| Luminous Efficacy    | 87lm/W                 |
| CRI(Color Rendering) | Ra>94                  |
| LED Source           | Bridgelux COB (Option) |
| Flicker Free         | Less than 1%           |
| Certification        | KC                     |
| Track type           | DC Track               |
| Finish Color         | Black & White          |

|                  |                         |
|------------------|-------------------------|
| Communication    | Bluetooth Mesh 5.x      |
|                  | RF 315Mhz               |
| Pan              | 350°                    |
| Tilt             | 90°                     |
| CCT              | 2700K~6500K             |
| Beam angle(Zoom) | 20°~65°                 |
| Dimming          | 5%~100%                 |
| App              | Android                 |
| Max Connections  | 32,000                  |
| Control Range    | Up to 30m               |
| Scene Settings   | Supported               |
| Lens Material    | Silicon, PMMA(Optional) |
| Accessories      | Remote controller       |

# DL-35

DMuseum Inc. Motorized Smart Lighting



35W

CRI  
94

2700K~  
6500K



## Custom Downlight for Enhanced Exhibition Value

The DL-35 is a 35W motorized smart downlight with Bluetooth and RF control. With 340° pan,  $\pm 45^\circ$  tilt, and adjustable CCT (2700K-6500K), it supports precise lighting from ceilings, walls, and floors. Dimming and zoom functions enhance focus and mood, while its clean design blends naturally into exhibition spaces—maximizing visual impact.

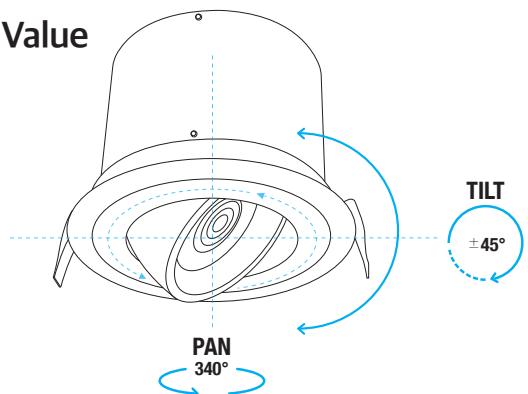

# Dimensions



|                      |                        |
|----------------------|------------------------|
| Input Voltage        | AC 100-240V            |
| Power Consumption    | 35W                    |
| Output Voltage       | DC 48V                 |
| Frequency            | 50/60Hz                |
| Control Method       | CC/CV Control Method   |
| Luminous Flux        | 2200lm                 |
| Luminous Efficacy    | 92lm/w                 |
| CRI(Color Rendering) | Ra>90                  |
| LED Source           | Bridgelux COB (Option) |
| Flicker Free         | Less than 1%           |
| Certification        | KC, CE                 |
| Finish Color         | Black & White          |

|                  |                         |
|------------------|-------------------------|
| Communication    | RF 315Mhz               |
| Pan              | 340°                    |
| Tilt             | 90°                     |
| CCT              | 2700K~6500K             |
| Beam angle(Zoom) | 10°, 23°, 36°           |
| Dimming          | 5%~100%                 |
| App              | Android                 |
| Max Connections  | 32,000                  |
| Control Range    | Up to 30m               |
| Scene Settings   | Supported               |
| Lens Material    | Silicon, PMMA(Optional) |
| Accessories      | Remote controller       |

# 4-wire 3-phase Track system



## Structure

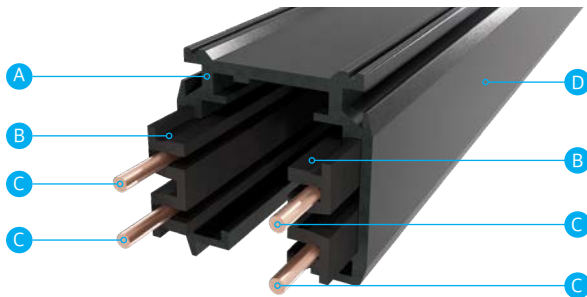

- A.** High-strength aluminum alloy housing for excellent durability and thermal conductivity
- B.** Flame-retardant PVC strips ensure superior insulation and electrical safety
- C.** High-conductivity copper strips for reliable power transmission
- D.** Dual-color finish (White, Black) for seamless spatial integration

## Size

### DM-401N Series (Surface-mounted)

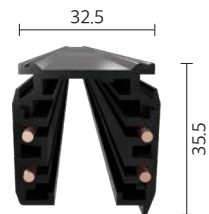

### DM-401W Series (Recessed)

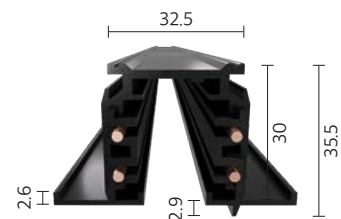

# 4-wire 3-phase Track system

DMUSEUM Inc.'s track system features three independent circuit channels that evenly distribute electrical load and enhance power supply stability.It supports both surface-mounted and recessed installations without the need for a bridge frame. The modular design allows multiple lighting fixtures to be flexibly arranged on a single rail, making it suitable for exhibition environments as well as large-scale commercial spaces.



Circuit Connection Diagram

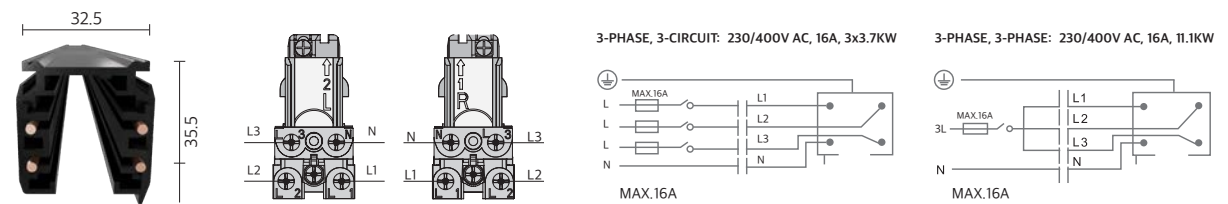

| Type            | Model     | Track length | Material           | Package | Product Color      |
|-----------------|-----------|--------------|--------------------|---------|--------------------|
| Surface-mounted | DM-401N10 | 1000mm       | Aluminum extrusion | 1/12    | White, Black, Gray |
|                 | DM-401N15 | 1500mm       | Aluminum extrusion | 1/12    | White, Black, Gray |
|                 | DM-401N20 | 2000mm       | Aluminum extrusion | 1/12    | White, Black, Gray |
|                 | DM-401N30 | 3000mm       | Aluminum extrusion | 1/12    | White, Black, Gray |
| Recessed        | DM-401W10 | 1000mm       | Aluminum extrusion | 1/12    | White, Black, Gray |
|                 | DM-401W15 | 1500mm       | Aluminum extrusion | 1/12    | White, Black, Gray |
|                 | DM-401W20 | 2000mm       | Aluminum extrusion | 1/12    | White, Black, Gray |
|                 | DM-401W30 | 3000mm       | Aluminum extrusion | 1/12    | White, Black, Gray |

# 4-wire 3-phase Track system

## Track Connectors

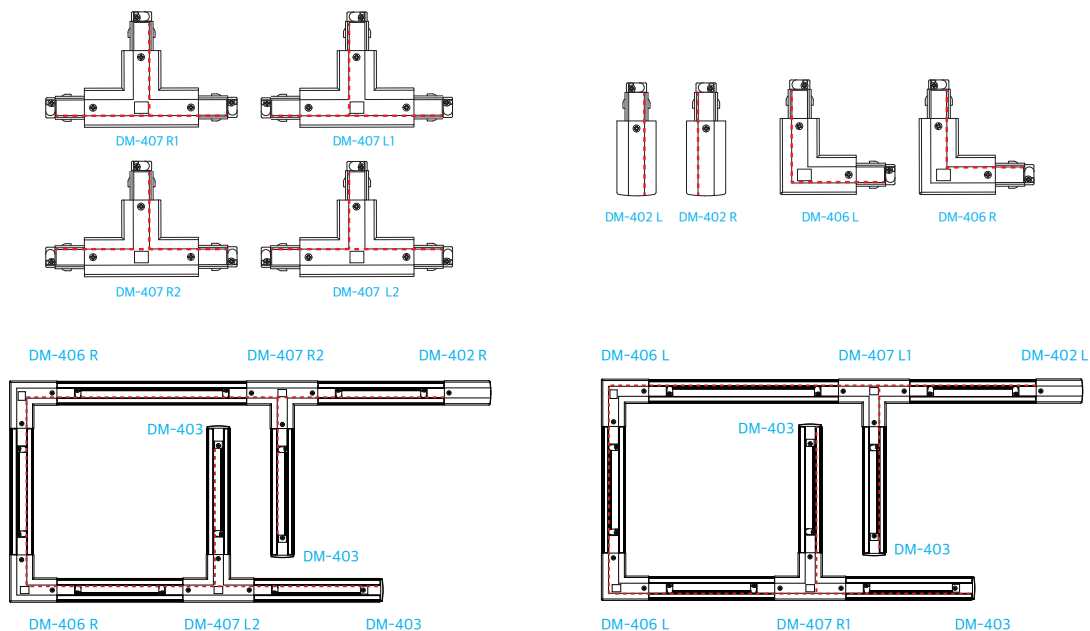

### PowerEnd Connector

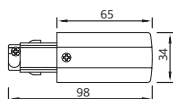

| Model    | Material |
|----------|----------|
| DM-402 L | PC       |
| DM-402 R | PC       |

### End Cap

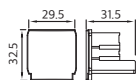

| Model  | Material |
|--------|----------|
| DM-403 | PC       |

### L Connector

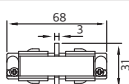

| Model    | Material |
|----------|----------|
| DM-404 L | PC       |
| DM-404 R | PC       |

### X Connector

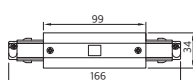

| Model  | Material |
|--------|----------|
| DM-405 | PC       |

### Mini Joiner

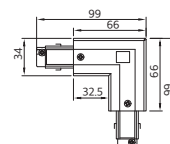

| Model  | Material |
|--------|----------|
| DM-406 | PC       |

### Straight Connector

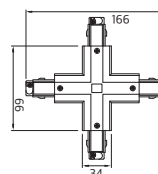

| Model  | Material |
|--------|----------|
| DM-408 | PC       |

### Flexible Connector

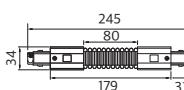

| Model  | Material |
|--------|----------|
| DM-409 | PC       |

### T Connector

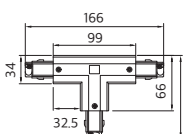

| Model  | Material |
|--------|----------|
| DM-407 | PC       |

# 4-wire 3-phase Track system

## Track Installation Guide

### 1 Power & Connector Setup

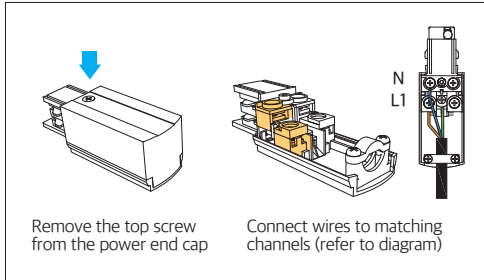

Wire the end cap as shown in the diagram above.

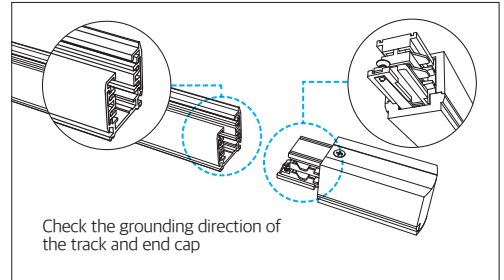

Align and insert the end cap into the track.

### 2 Mount Fixture

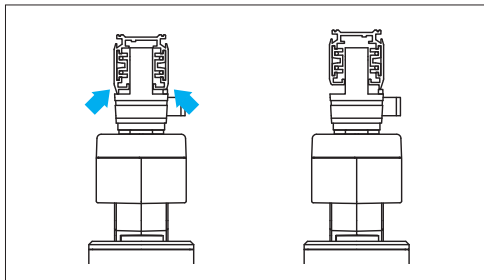

Match the adapter tabs with the track grooves.

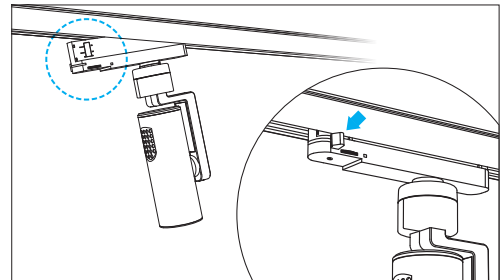

Insert the side without the locking lever first and push in and lock the lever securely.

### 3 Connect Power

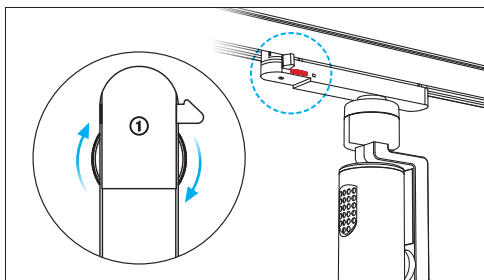

Rotate the adapter dial to align with the L1 Channel.

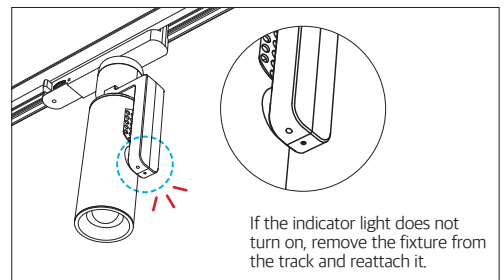

Once installed, check the indicator light to confirm power connection.

## Smart Lighting Control system

# Technology That Completes the Space

DMUSEUM's smart lighting system uses Bluetooth MESH to reliably control multiple fixtures wirelessly. Users can adjust CCT, dimming, pan, tilt, and power—or set custom lighting schedules from anywhere. Our Android-compatible app and remote controller provide intuitive, real-time control.

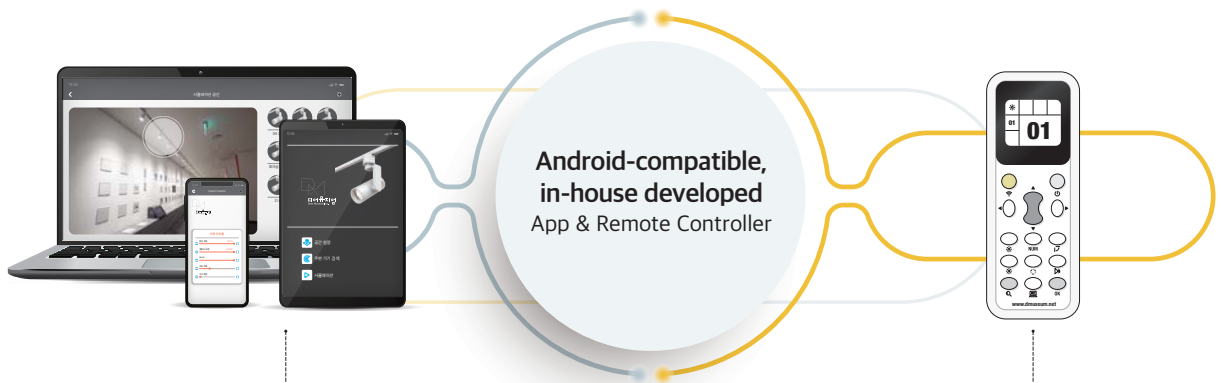

# Smart Lighting Control system

## Remote Controller Button Guide

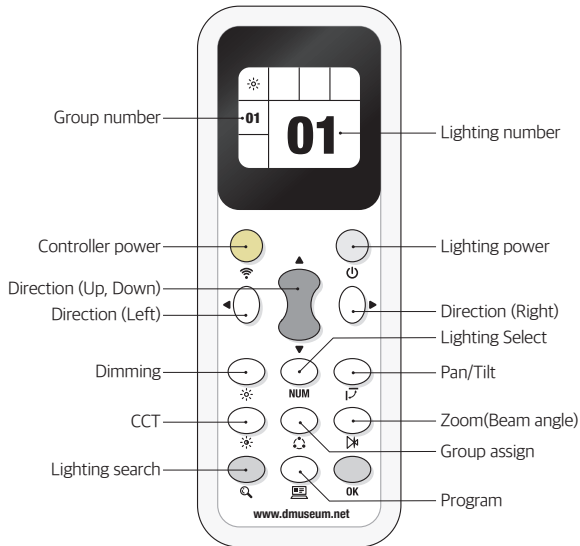

### Assigning Lighting Number

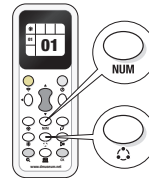

- Press the lighting select button
- Use the Direction button to choose a lighting
- After pairing, press the program button for 3+ seconds

※ For group assignment, then follow the same direction assignment process.

### Bluetooth Reset

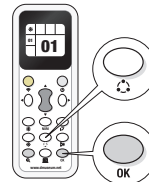

- Press the lighting select button
- Press and hold both the program and OK button for more than 3 seconds.

## How to Use the Remote

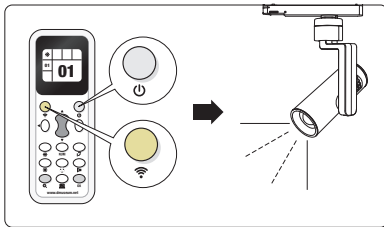

### Power ON/OFF

Press the power button to turn the controller and lighting on or off.

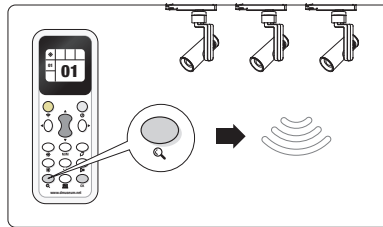

### Lighting Search

Hold the lighting search button for 3 seconds to automatically detect nearby fixtures.

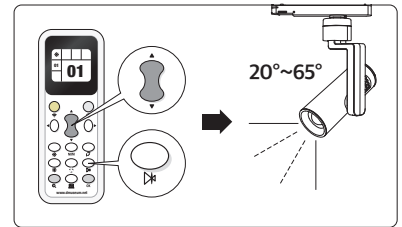

### Zoom Control

Press the Zoom button, then use up/down arrows to adjust beam angle size. (20°~65°)

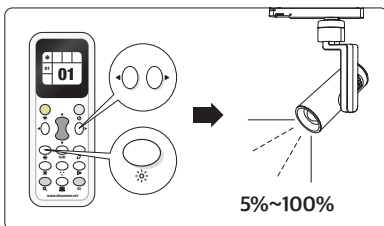

### Brightness Control

Press the dimming button, then use left/right arrows to adjust brightness. (5%~100%)

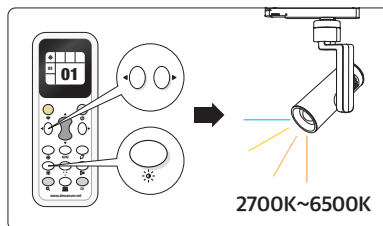

### CCT Control

Press the CCT button, then use left/right arrow to adjust color temperature. (2700K to 6500K)

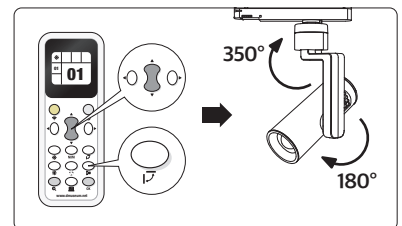

### Pan/Tilt Adjustment

Press the pan/tilt button, then use up/down arrows to control lighting direction. (pan : 350°, tilt : 180°)

# Smart Lighting Control system

## How to Use the App

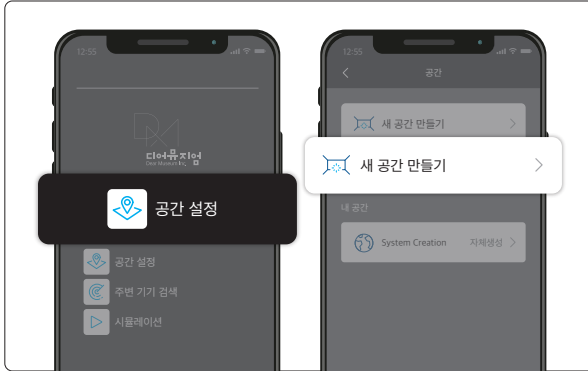

Tap "Space Settings" on the home screen after launching the app to create a new space.



In the lighting control screen, tap the [+] icon at the top right to register a new device.

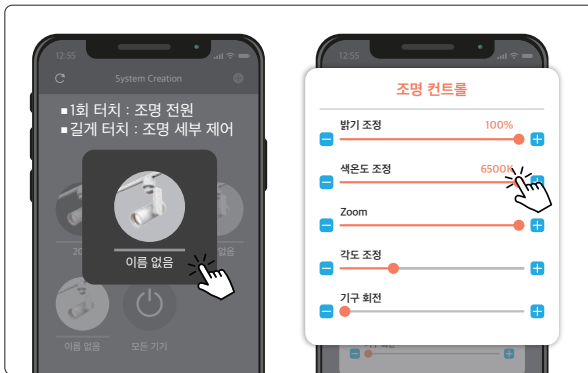

Tap the lighting icon to turn on the device.  
Press and hold for 2 seconds to open the control panel to adjust dimming, zoom, CCT, pan and tilt.



In the image control screen, tap [+] at the top right.  
Register or capture a photo and set the image name.

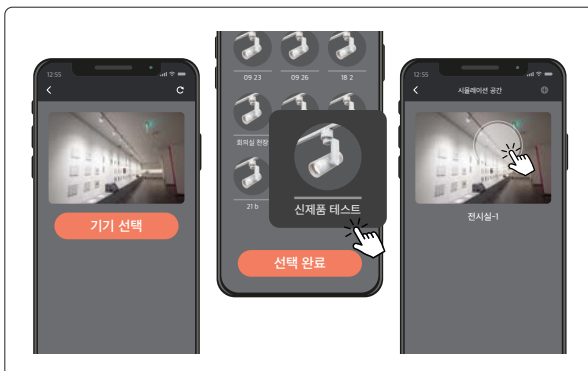

Tap the "Device Mapping" button and drag each registered device onto the corresponding lighting position in the image to align spatially.



Select device for a group or scene, then set the operating time, delay options and save to apply.

# Smart Lighting Control system

## App Flow Chart

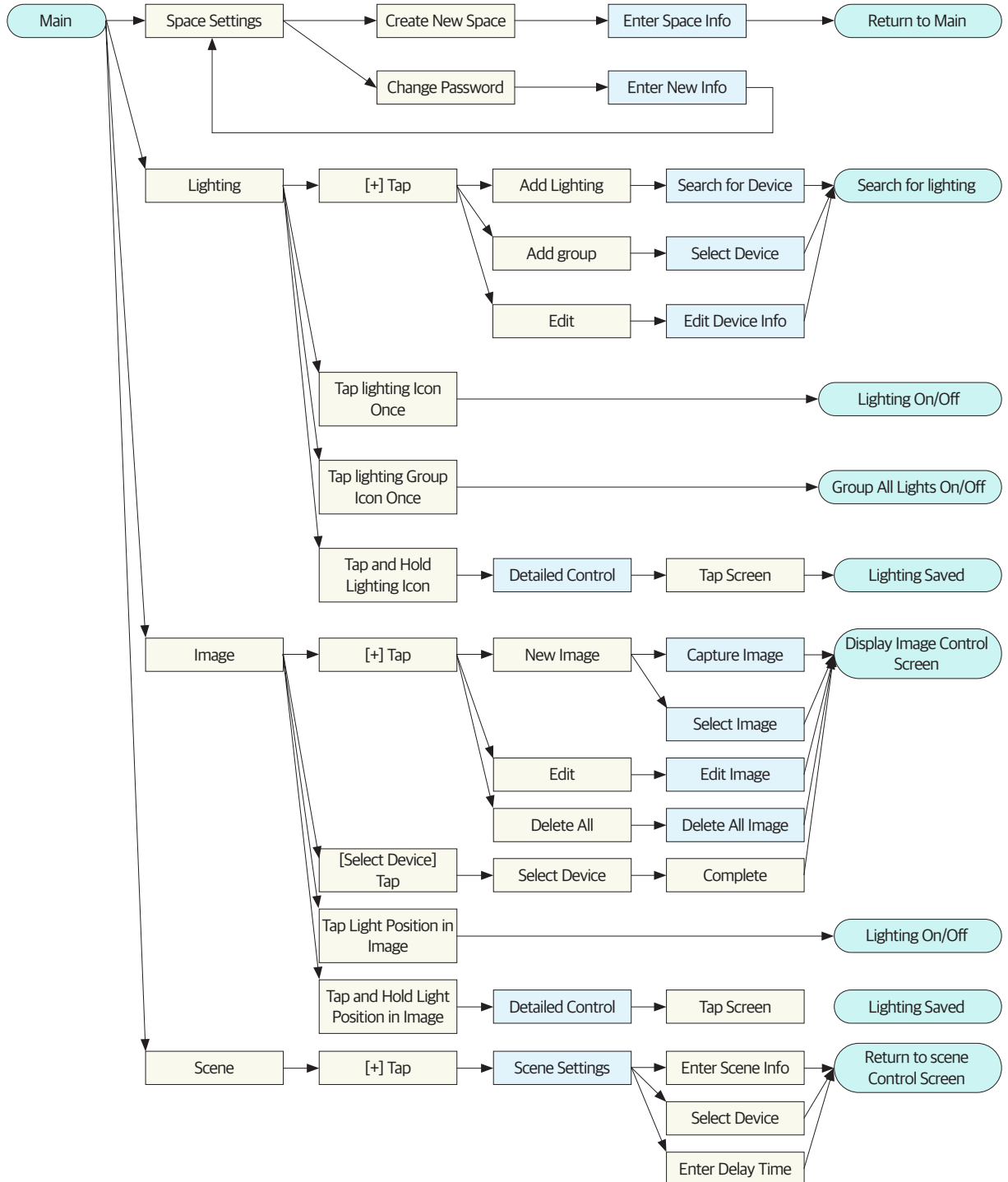

[illegible][illegible]

**특허증**  
CERTIFICATE OF PATENT

**특허** 제 10-1510540 호  
Patent No. 10-1510540

**출원인** 제 10-2012-012349 호  
Applicant No. 10-2012-012349

**출원일자** 2012년 01월 25일  
Filing Date 2012.01.25

**특허일자** 2013년 04월 25일  
Patent Date 2013.04.25

**출원번호** 제 10-2012-012349 호  
Application No. 10-2012-012349

**특허번호** 제 10-1510540 호  
Patent No. 10-1510540

**특허권자** 이인산  
Patentee 이인산

**특허권** 디자인권  
Right of Patent Design

본 특허는 「특허법」 제 44조의 특허권자에게 등록한 디자인을 증명함이다.  
This is to certify that, in accordance with the Patent Act, a patent for the invention has been registered for the Korean Intellectual Property Office.

특허청장은 「특허법」 제 44조의 특허권자에게 등록한 디자인을 증명함이다.  
This is to certify that, in accordance with the Patent Act, a patent for the invention has been registered for the Korean Intellectual Property Office.

2013년 04월 25일

**특허청장**  
COMMISSIONER  
KOREAN INTELLECTUAL PROPERTY OFFICE

**이인산**

제 20299 호

상 장

국회회사 다국지업

러는 국회과학기술연구소 신기술 개발 우수업체  
선정대회에서 「로라 국통 스마트조명 제어  
시스템과 통합솔루션 기술」을 출품하여 우수한  
성적을 거두었으므로 이 성장을 축하합니다.

2024년 6월 26일

산업통상자원부차관  
안 덕

[illegible][illegible][illegible]

한국전쟁 기념비  
 韓國戰爭 紀念碑



## 인연확인신고서 증명서

### Corroboration Letter of Declaration

1. 성명 (Name)

2. 생년월일 (Date of Birth)

3. 주민등록번호 (Resident Registration Number)

4. 주소 (Address)

5. 직업 (Occupation)

6. 학력 (Education)

7. 군종 (Service Branch)

8. 군종 (Service Branch)

9. 군종 (Service Branch)

10. 군종 (Service Branch)

11. 군종 (Service Branch)

12. 군종 (Service Branch)

13. 군종 (Service Branch)

14. 군종 (Service Branch)

15. 군종 (Service Branch)

16. 군종 (Service Branch)

17. 군종 (Service Branch)

18. 군종 (Service Branch)

19. 군종 (Service Branch)

20. 군종 (Service Branch)

21. 군종 (Service Branch)

22. 군종 (Service Branch)

23. 군종 (Service Branch)

24. 군종 (Service Branch)

25. 군종 (Service Branch)

26. 군종 (Service Branch)

27. 군종 (Service Branch)

28. 군종 (Service Branch)

29. 군종 (Service Branch)

30. 군종 (Service Branch)

31. 군종 (Service Branch)

32. 군종 (Service Branch)

33. 군종 (Service Branch)

34. 군종 (Service Branch)

35. 군종 (Service Branch)

36. 군종 (Service Branch)

37. 군종 (Service Branch)

38. 군종 (Service Branch)

39. 군종 (Service Branch)

40. 군종 (Service Branch)

41. 군종 (Service Branch)

42. 군종 (Service Branch)

43. 군종 (Service Branch)

44. 군종 (Service Branch)

45. 군종 (Service Branch)

46. 군종 (Service Branch)

47. 군종 (Service Branch)

48. 군종 (Service Branch)

49. 군종 (Service Branch)

50. 군종 (Service Branch)

51. 군종 (Service Branch)

52. 군종 (Service Branch)

53. 군종 (Service Branch)

54. 군종 (Service Branch)

55. 군종 (Service Branch)

56. 군종 (Service Branch)

57. 군종 (Service Branch)

58. 군종 (Service Branch)

59. 군종 (Service Branch)

60. 군종 (Service Branch)

61. 군종 (Service Branch)

62. 군종 (Service Branch)

63. 군종 (Service Branch)

64. 군종 (Service Branch)

65. 군종 (Service Branch)

66. 군종 (Service Branch)

67. 군종 (Service Branch)

68. 군종 (Service Branch)

69. 군종 (Service Branch)

70. 군종 (Service Branch)

71. 군종 (Service Branch)

72. 군종 (Service Branch)

73. 군종 (Service Branch)

74. 군종 (Service Branch)

75. 군종 (Service Branch)

76. 군종 (Service Branch)

77. 군종 (Service Branch)

78. 군종 (Service Branch)

79. 군종 (Service Branch)

80. 군종 (Service Branch)

81. 군종 (Service Branch)

82. 군종 (Service Branch)

83. 군종 (Service Branch)

84. 군종 (Service Branch)

85. 군종 (Service Branch)

86. 군종 (Service Branch)

87. 군종 (Service Branch)

88. 군종 (Service Branch)

89. 군종 (Service Branch)

90. 군종 (Service Branch)

91. 군종 (Service Branch)

92. 군종 (Service Branch)

93. 군종 (Service Branch)

94. 군종 (Service Branch)

95. 군종 (Service Branch)

96. 군종 (Service Branch)

97. 군종 (Service Branch)

98. 군종 (Service Branch)

99. 군종 (Service Branch)

100. 군종 (Service Branch)

101. 군종 (Service Branch)

102. 군종 (Service Branch)

103. 군종 (Service Branch)

104. 군종 (Service Branch)

105. 군종 (Service Branch)

106. 군종 (Service Branch)

107. 군종 (Service Branch)

108. 군종 (Service Branch)

109. 군종 (Service Branch)

110. 군종 (Service Branch)

111. 군종 (Service Branch)

112. 군종 (Service Branch)

113. 군종 (Service Branch)

114. 군종 (Service Branch)

115. 군종 (Service Branch)

116. 군종 (Service Branch)

117. 군종 (Service Branch)

118. 군종 (Service Branch)

119. 군종 (Service Branch)

120. 군종 (Service Branch)

121. 군종 (Service Branch)

122. 군종 (Service Branch)

123. 군종 (Service Branch)

124. 군종 (Service Branch)

125. 군종 (Service Branch)

126. 군종 (Service Branch)

127. 군종 (Service Branch)

128. 군종 (Service Branch)

129. 군종 (Service Branch)

130. 군종 (Service Branch)

131. 군종 (Service Branch)

132. 군종 (Service Branch)

133. 군종 (Service Branch)

134. 군종 (Service Branch)

135. 군종 (Service Branch)

136. 군종 (Service Branch)

137. 군종 (Service Branch)

138. 군종 (Service Branch)

139. 군종 (Service Branch)

140. 군종 (Service Branch)

141. 군종 (Service Branch)

142. 군종 (Service Branch)

143. 군종 (Service Branch)

144. 군종 (Service Branch)

145. 군종 (Service Branch)

146. 군종 (Service Branch)

147. 군종 (Service Branch)

148. 군종 (Service Branch)

149. 군종 (Service Branch)

150. 군종 (Service Branch)

151. 군종 (Service Branch)

152. 군종 (Service Branch)

153. 군종 (Service Branch)

154. 군종 (Service Branch)

155. 군종 (Service Branch)

156. 군종 (Service Branch)

157. 군종 (Service Branch)

158. 군종 (Service Branch)

159. 군종 (Service Branch)

160. 군종 (Service Branch)

161. 군종 (Service Branch)

162. 군종 (Service Branch)

163. 군종 (Service Branch)

164. 군종 (Service Branch)

165. 군종 (Service Branch)

166. 군종 (Service Branch)

167. 군종 (Service Branch)

168. 군종 (Service Branch)

169. 군종 (Service Branch)

170. 군종 (Service Branch)

171. 군종 (Service Branch)

172. 군종 (Service Branch)

173. 군종 (Service Branch)

174. 군종 (Service Branch)

175. 군종 (Service Branch)

176. 군종 (Service Branch)

177. 군종 (Service Branch)

178. 군종 (Service Branch)

179. 군종 (Service Branch)

180. 군종 (Service Branch)

181. 군종 (Service Branch)

182

38

## CONTACT US

# DMUSEUM Inc.

[www.DMuseum.net](http://www.DMuseum.net)

### Address

#### Head Office

A-103, Giheung ICT Valley, 58-1, Giheung-ro,  
Giheung-gu, Yongin-si, Gyeonggi-do,  
Republic of Korea

#### Factory

11-2, Jisam-ro 250beon-gil, Giheung-gu,  
Yongin-si, Gyeonggi-do, Republic of Korea

### Contact

Tel. +82-31-548-2830  
[info@dmuseum.net](mailto:info@dmuseum.net)





DMuseum

## Contact us

### **www.DMuseum.net**

Smart Lighting development  
Exhibition Design  
Media Content Production

### **Address**

A-103, Giheung ICT Valley, 58-1, Giheung-ro,  
Giheung-gu, Yongin-si, Gyeonggi-do,  
Republic of Korea

### **Contact**

Tel. +82-31-548-2830  
info@dmuseum.net